

机构特性:

1. 胶壳: LCP料, UL94V-0, 黑色;
2. 金针: 0.35*0.46mm扁针, 磷青铜, 镀金GF-50u", 镍底50u", 剥头电镀雾锡120u";
3. SMT端子: 0.40mm厚黄铜, 镀镍底50u", 镀锡120u";
4. 信赖性: 大于750次插拔;
5. 插入/拔出力: 30N Max;
6. 配合强度: 50N 60S±5S.
7. 产品过炉后与PCB的保持力30N Min

电气特性

1. 额定电压: 150 VAC RMS
 2. 额定电流: 1.5 AMP
 3. 接触电阻: 20 mΩ MAX.
 4. 绝缘电阻: 500 MΩ MIN.@500 VDC
 5. 耐压强度: 1500 V DC 或 1000V AC
RMS @ 0.5mA 50 Hz 或 60 Hz 一分钟
- 环境特性:

1. 储存温度: -40°C~+85°C 相对湿度<80%
2. 工作温度: -40°C~+85°C

NOTES:

ELECTRICAL:

1. VOLTAGE RATING : 150 VAC RMS.
2. CURRENT RATING : 1.5 AMP.
3. CONTACT RESISTANCE : 20 MILLIOHMS MAX.
4. INSULATION RESISTANCE: 500 MEGOHMS MIN @ 500 VDC
5. DIELECTRIC STRENGTH : 1500 V DC OR 1000V AC RMS @ 0.5mA 50 Hz / 60 Hz 1 Minute

MECHANICAL:

1. HOUSING&INSERT& MATERIAL: LCP UL94V-0. COLOR BLACK
2. CONTACT MATERIAL : PHOSPHOR BRONZE T=0.35mm
50U"MIN,NICKEL PLATED OVERALL
120U"MIN,TIN(LEAD FREE)PLATED AT SOLDER TAIL
GF~50U"GOLD PLATED AT CONTACT AREA
3. PAD MATERIAL : COPPER
120u"MIN.TIN(LEAD FREE)PLATED OVERALL,
50u"MIN.NICKEL UNDER PLATING
4. OPERATING LIFE : 750 CYCLES MIN.
5. MATING/UNMATING FORCE: : 30N Max.
6. RETENTION STRENGTH: : 50N FOR 60S±5S.

ENVIRONMENTAL:

1. STORAGE : -40°C TO +85°C RELATIVE HUMIDITY<80%.
 2. OPERATION : -40°C TO +85°C.
- MATES WITH MODULAR PLUG CONFORMING TO
FCC PART 68, SUBPART F.
ROHS PART NUMBER:

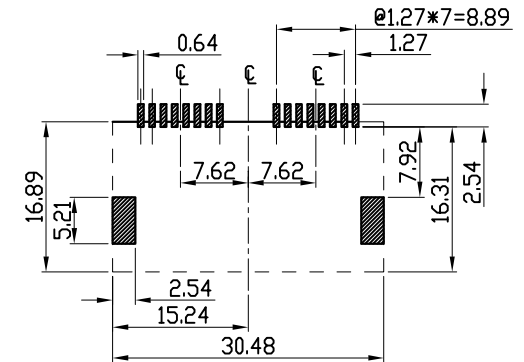
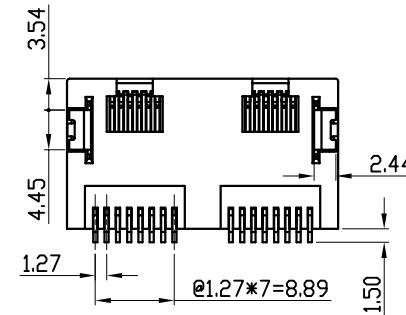
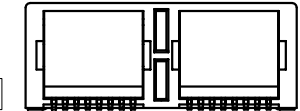
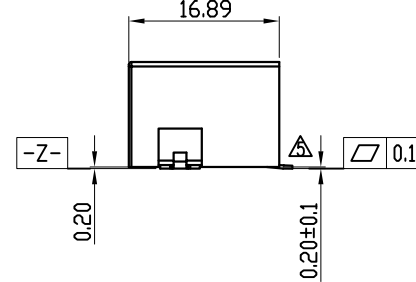
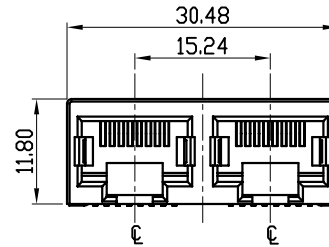
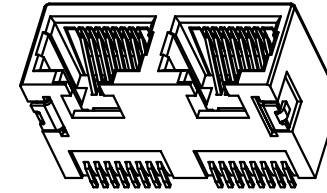
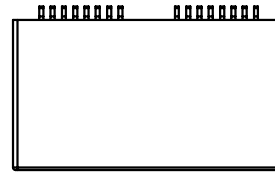

PC BOARD LAYOUT
(COMPONENT SIDE OF BOARD)

RoHS Compliant

RJ45 SMT 8P8C 双胞胎插座

第一视角 A4 SIZE SCALE 比例 1:1 UNIT 单位 mm CUSTOMER: 客户 N/A MODEL NO: 料号 N/A		TOLERANCES 公差 00-15 ±0.15 15-30 ±0.20 30~ ±0.25 ANGLES: ±1°		Material: 材质 LCP Finish: 电镀 GF~50u"	Designed: 设计 刘励冶 Checked: 审核 刘励冶 Approved: 核准 刘励冶	NAME: 名称 RJ45 1*2 SMT PCB JACK DWG NO: 图号 PART NO: 料号	REV. 版本 07
		SHEET 1 OF 1 第 1 页 共 1 页					